

## Multipol CPV10-VI-P...

# FESTO

Festo AG & Co. KG

Postfach  
D-73726 Esslingen  
++49/(0)711/347-0  
www.festo.com

Type	A ± 0,1	B ± 0,1	C ± 0,1	D ± 0,1	N
CPV10-VI-P...-C [2]					
P2	53	59	64	62	6
P4	53	79	64	82	6
P6	53	99	64	102	6
P8	53	119	64	122	6

### 1. Teileliste

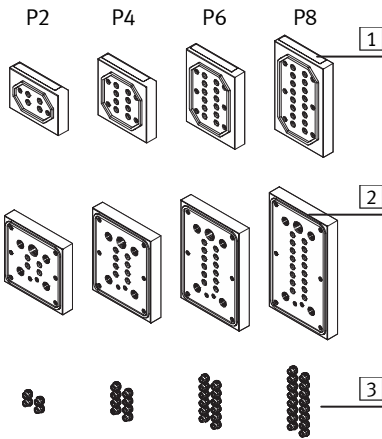

- [1] Multipol  
CPV10-VI-P...-D
- [2] Multipol  
CPV10-VI-P...-C
- [3] Dichtungen  
CPV10-VI-P.M7

### 2. Vorbereitung zur Montage

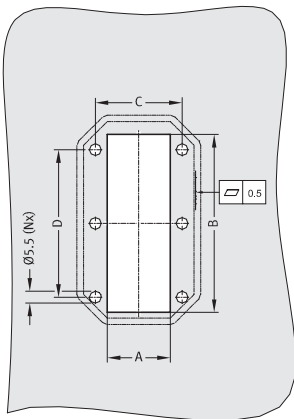

- Beachten Sie notwendige Maße für den Montageausschnitt (→ Tabelle). Um die Schutzart IP65 zu gewährleisten.
- Stellen Sie sicher, dass die Fläche im Bereich der Dichtfläche:
  - eben ist.
  - frei von Riefen und Kratzer ist.

Montageausschnitt für  
CPV10-VI-P...-D [1]

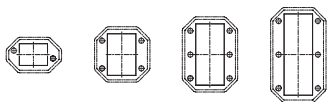

Type	A ± 0,1	B ± 0,1	C ± 0,1	D ± 0,1	N
CPV10-VI-P...-D [1]					
P2	29	22	40	8	2
P4	29	42	40	28	4
P6	29	62	40	48	6
P8	29	82	40	68	6

### 3. Montage

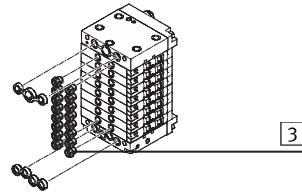

- Drücken Sie alle beigelegten Dichtungen [3] in die Bohrungen der CPV-Ventilinsel.
- Beachten Sie, dass die 3er- und 4er-Dichtungen, die den Endplatten der CPV-Ventilinsel beigelegt sind, nur bei Multipol [2] notwendig sind.
- Positionieren Sie den Multipol [1] bzw. [2] von innen am Montageausschnitt.

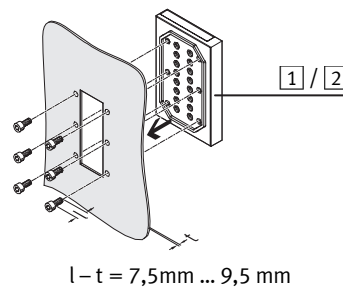
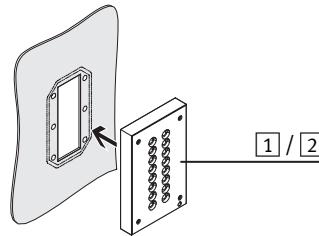

- Befestigen Sie den Multipol [1] bzw. [2] mit N x M5 korrosionsbeständigen Schrauben nach DIN EN ISO 4762.
- Wählen Sie die Schraubenlänge l wie folgt. Es muss eine Einschraubtiefe der Schrauben von mind. 7,5 mm bis max. 9,5 mm gewährleistet sein.
- Drehen Sie die Schrauben fest. Halten Sie das zulässige Anziehdrehmoment ein.

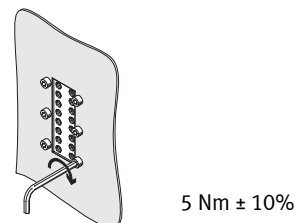

Zur Befestigung der Ventilinsel CPV10:

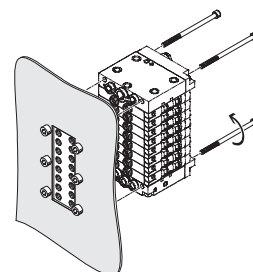

- Beachten Sie die Montagehinweise aus der zugehörigen Pneumatik-Beschreibung der Ventilinsel.

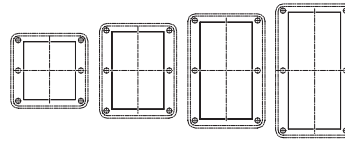

## Multiple connector plate CPV10-VI-P...

# FESTO

Festo AG & Co. KG

Postfach  
D-73726 Esslingen  
++49/(0)711/347-0  
www.festo.com

Type	A ± 0.1	B ± 0.1	C ± 0.1	D ± 0.1	N
CPV10-VI-P...-C [2]					
P2	53	59	64	62	6
P4	53	79	64	82	6
P6	53	99	64	102	6
P8	53	119	64	122	6

### 1. Parts list

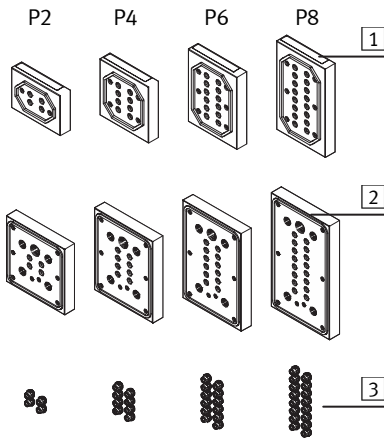

- [1] Multiple connector plate  
CPV10-VI-P...-D
- [2] Multiple connector plate  
CPV10-VI-P...-C
- [3] Seals  
CPV10-VI-P.M7

### 2. Preparing for assembly

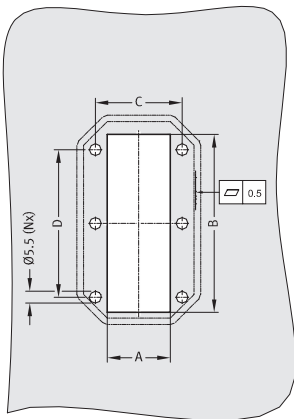

- Note the dimensions of the cut-out for fitting (→ Table).
- In order to comply with protection class IP65:
  - Make sure that the surface near the sealing surface:
    - is flat.
    - is free of marks and scratches.

Mounting cut-out for  
CPV10-VI-P...-D [1]

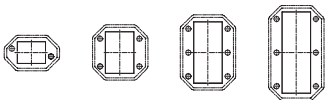

Type	A ± 0.1	B ± 0.1	C ± 0.1	D ± 0.1	N
CPV10-VI-P...-D [1]					
P2	29	22	40	8	2
P4	29	42	40	28	4
P6	29	62	40	48	6
P8	29	82	40	68	6

### 3. Assembly

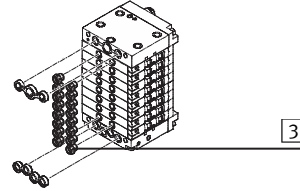

- Press the seals [3] supplied into the holes in the CPV valve terminal.
- Note that the 3 and 4-part seals supplied with the end plates of the CPV valve terminal are only required with multiple connector plate [2].
- Position multiple connector plate [1] or [2] in the mounting cut-out from inside.

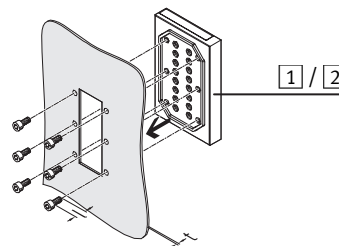
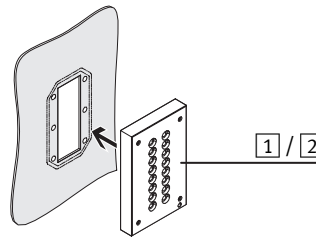

- Fasten the multiple connector plate [1] or [2] with corrosion resistant N x M5 screws as per DIN EN ISO 4762.
- Select the screw length l as follows. A screw depth of at least 7.5 mm to max. 9.5 mm must be guaranteed.
- Tighten the screws. Maintain the permitted tightening torque.

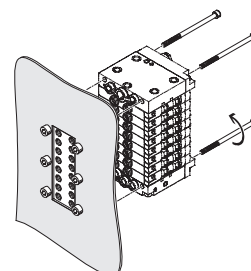
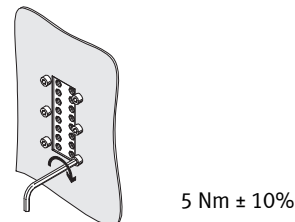

- For mounting the valve terminal CPV10:
- Observe the assembly instructions for the pneumatic section of the valve terminal.