

Multipol CPV14-VI-P...

FESTO

Festo AG & Co. KG

Postfach
D-73726 Esslingen
++49/(0)711/347-0
www.festo.com

1. Teileliste

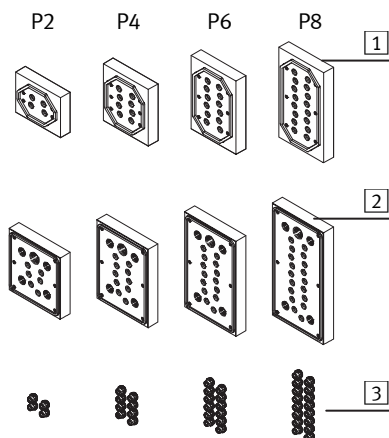

- 1 Multipol
CPV14-VI-P...-D
- 2 Multipol
CPV14-VI-P...-C
- 3 Dichtungen
CPV14-VI-P.1/8

2. Vorbereitung zur Montage

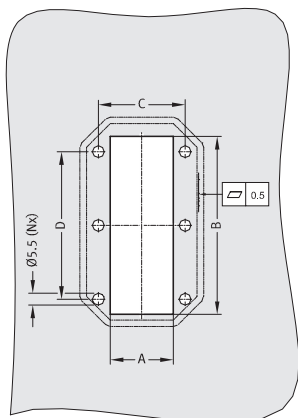

- Beachten Sie notwendige Maße für den Montageausschnitt (→ Tabelle). Um die Schutzart IP65 zu gewährleisten.
- Stellen Sie sicher, dass die Fläche im Bereich der Dichtfläche:
 - eben ist.
 - frei von Riefen und Kratzer ist.

Montageausschnitt für
CPV14-VI-P...-D 1

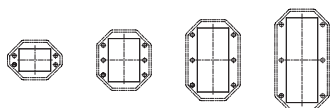

Typ	A ± 0,1	B ± 0,1	C ± 0,1	D ± 0,1	N
CPV14-VI-P...-D 1					
P2	42,6	30,5	55,6	12	4
P4	42,6	58,5	55,6	40	6
P6	42,6	86,5	55,6	68	6
P8	42,6	114,5	55,6	96	6

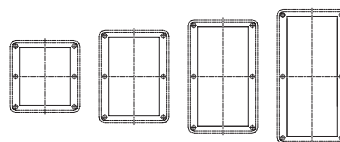

Montageausschnitt für
CPV14-VI-P...-C 2

Typ	A ± 0,1	B ± 0,1	C ± 0,1	D ± 0,1	N
CPV14-VI-P...-C 2					
P2	68	78	79	82	6
P4	68	106	79	110	6
P6	68	134	79	138	6
P8	68	162	79	166	6

3. Montage

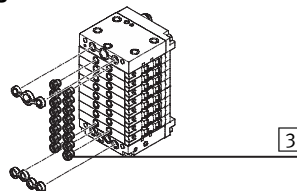

- Drücken Sie alle beigelegten Dichtungen 3 in die Bohrungen der CPV-Ventilinsel.
- Beachten Sie, dass die 3er- und 4er-Dichtungen, die den Endplatten der CPV-Ventilinsel beigelegt sind, nur bei Multipol 2 notwendig sind.
- Positionieren Sie den Multipol 1 bzw. 2 von innen am Montageausschnitt.

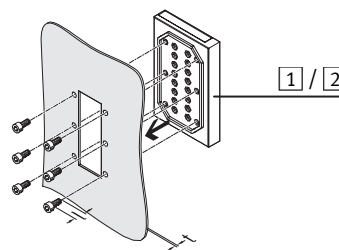
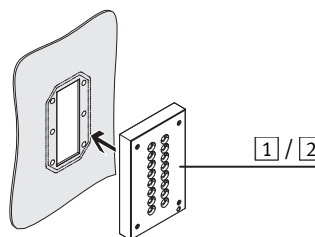

$l - t = 7,5 \text{ mm} \dots 9,5 \text{ mm}$

- Befestigen Sie den Multipol 1 bzw. 2 mit N x M5 korrosionsbeständigen Schrauben nach DIN EN ISO 4762.
- Wählen Sie die Schraubenlänge l wie folgt. Es muss eine Einschraubtiefe der Schrauben von mind. 7,5 mm bis max. 9,5 mm gewährleistet sein.
- Drehen Sie die Schrauben fest. Halten Sie das zulässige Anziehdrehmoment ein.

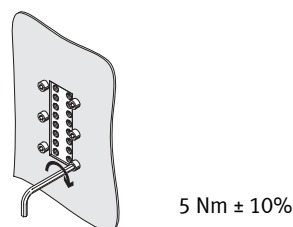

5 Nm ± 10%

Zur Befestigung der Ventilinsel CPV14:

- Beachten Sie die Montagehinweise aus der zugehörigen Pneumatik-Beschreibung der Ventilinsel.

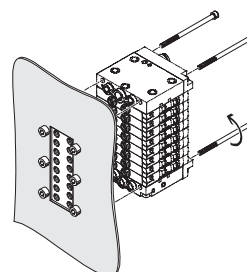

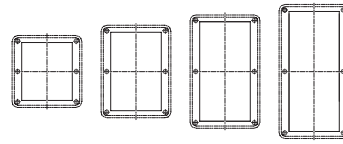

Mounting cut-out for
CPV14-VI-P...-C [2]

Multiple connector plate CPV14-VI-P...

FESTO

Festo AG & Co. KG

Postfach
D-73726 Esslingen
++49/(0)711/347-0
www.festo.com

1. Parts list

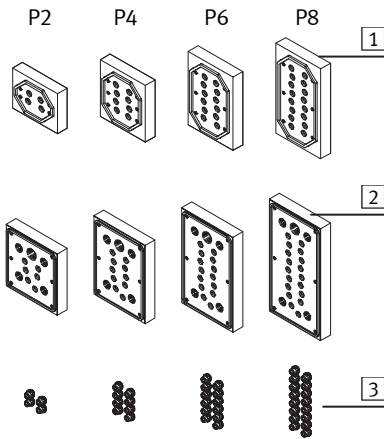

- [1] Multiple connector plate
CPV14-VI-P...-D
- [2] Multiple connector plate
CPV14-VI-P...-C
- [3] Seals
CPV14-VI-P.1/8

2. Preparing for assembly

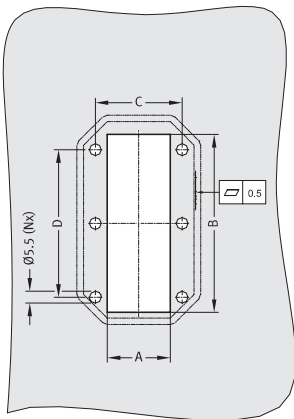

- Note the dimensions of the cut-out for fitting (→ Table).
- In order to comply with protection class IP65:
- Make sure that the surface near the sealing surface:
 - is flat.
 - is free of marks and scratches.

Mounting cut-out for
CPV14-VI-P...-D [1]

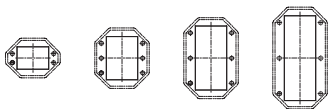

Type	A ± 0.1	B ± 0.1	C ± 0.1	D ± 0.1	N
CPV14-VI-P...-D [1]					
P2	42.6	30.5	55.6	12	4
P4	42.6	58.5	55.6	40	6
P6	42.6	86.5	55.6	68	6
P8	42.6	114.5	55.6	96	6

3. Assembly

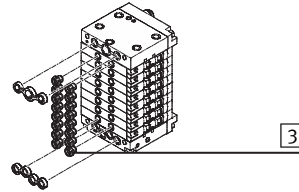

- Press the seals [3] supplied into the holes in the CPV valve terminal.
- Note that the 3 and 4-part seals supplied with the end plates of the CPV valve terminal are only required with multiple connector plate [2].
- Position multiple connector plate [1] or [2] in the mounting cut-out from inside.

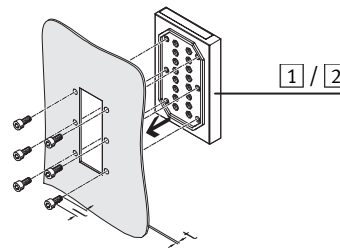
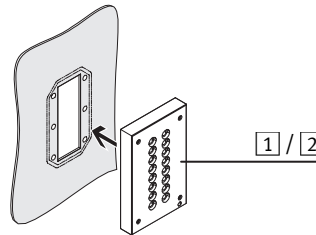

- Fasten the multiple connector plate [1] or [2] with corrosion resistant N x M5 screws as per DIN EN ISO 4762.
- Select the screw length l as follows. A screw depth of at least 7.5 mm to max. 9.5 mm must be guaranteed.
- Tighten the screws. Maintain the permitted tightening torque.

$l - t = 7.5 \text{ mm} \dots 9.5 \text{ mm}$

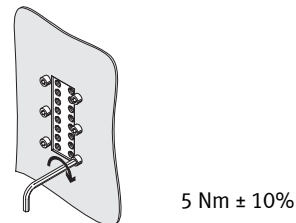

5 Nm ± 10%

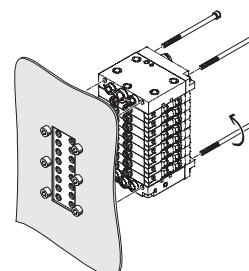

- For mounting the valve terminal:
- Observe the assembly instructions for the pneumatic section of the valve terminal.