

**FESTO**

Festo AG & Co. KG

Postfach  
73726 Esslingen  
Deutschland  
+49 711 347-0  
www.festo.com

**Adapterbausatz  
DHAA-G-G3/Q5-B13-HGDD/-HGDT**

**Info**

Der Bausatz enthält alle maximal erforderlichen Befestigungselemente.

- Beachten Sie, dass bei einigen Kombinationen Befestigungselemente übrig bleiben.

**Montage**

- Wählen Sie die Befestigungselemente (Schrauben, usw.) für Ihre Kombination (→ Tabelle).
- Beachten Sie die Bildzuordnung für Ihre Kombination (→ Tabelle).

**Bild 1**

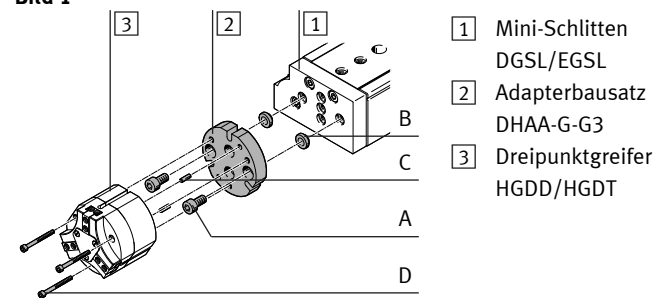

**Bild 2**

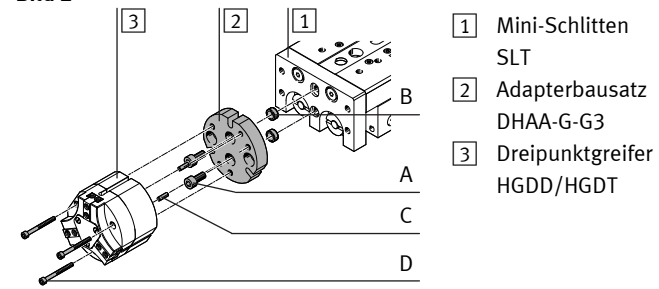

**Bild 3**

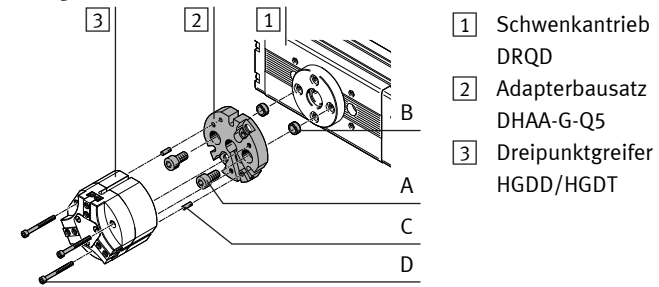

**Bild 4**

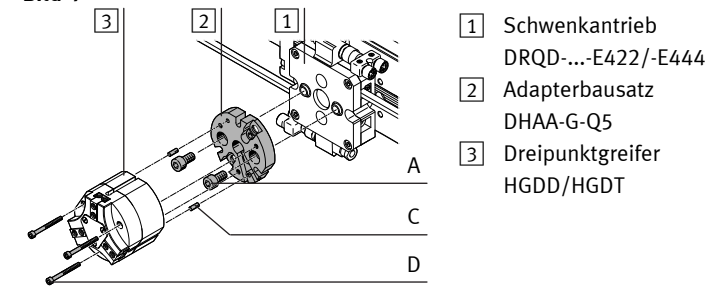

**Bild 5**

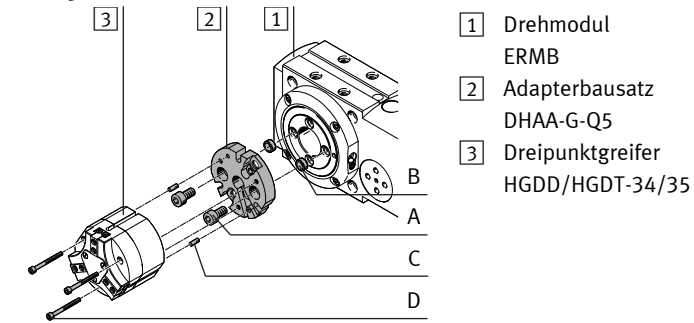

**Bild 6**

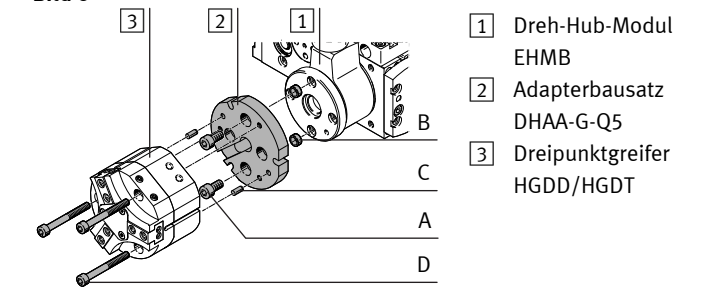

**Bild 7**



Bild	1	2	3	4	5	6	7	
1 Antrieb	DGSL- 16   20/25	EGSL- 45/55   75	SLT- 20   25	DRQD- 20   25/32   25/32	DRQD-...-E422/-E444- 20   25/32   25/32	ERMB- 20   25/32   25/32	EHMB- 20	HMX- 1
2 Bausatz	DHAA-G-G3-20- B13- 35	DHAA-G-G3-20- B13- 35	DHAA-G-G3-20- B13- 35	DHAA-G-Q5- 20-B13- 35   25-B13- 40	DHAA-G-Q5- 20-B13- 35   25-B13- 40	DHAA-G-Q5- 20-B13- 35   25-B13- 40	DHAA-G-Q5- 20-B13- 35   25-B13- 40	DHAA-G-G3-20- B13- 35
3 Greifer	HGDD-/HGDT- 35	HGDD-/HGDT- 35	HGDD-/HGDT- 35	HGDD-/HGDT- 35   40	HGDD-/HGDT- 35   40	HGDD-/HGDT- 35   40	HGDD-/HGDT- 35   40	HGDD-/HGDT- 35
	$M_A^{1)}$ [Nm]							
<b>A Zylinderschraube nach DIN 912</b>								
M4x10	3			2x			2x	
M4x30					2x			
M5x12	6	2x	2x	2x				2x
M6x12	10		2x	2x	2x	2x		2x
M6x16							2x	2x
M6x35					2x	2x		
<b>B Zentrierhülse</b>								
ZBV-9-7	2x		2x					
ZBV-12-9		2x		2x				
ZBH-7				2x			2x	
ZBH-9				2x	2x		2x	2x
ZBH-12				2x				
<b>C Zylinderstift nach DIN 6325</b>								
3m6x10		2x	2x	2x	2x	2x	2x	2x
4m6x10					2x		2x	2x
<b>D Zylinderschraube nach DIN 912</b>								
M3x30	1,2	3x	3x	3x	3x	3x	3x	3x
M5x30	6				3x	3x	3x	3x

<sup>1)</sup> Toleranzen für nicht tolerierte Anziehdrehmomente  $M_A$   
 $M_A > 1 \text{ Nm}$ : ± 20 %

**FESTO**

Festo AG & Co. KG

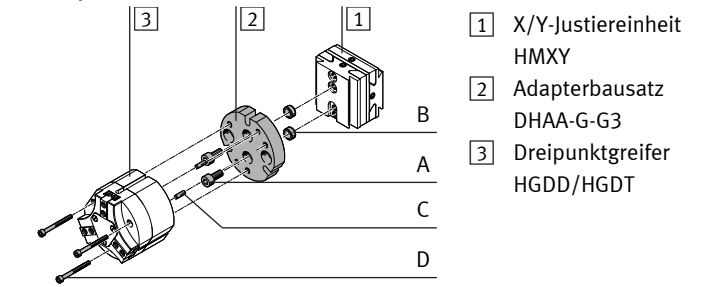
Postfach  
73726 Esslingen  
Germany  
+49 711 347-0  
www.festo.com

**Adapter kit  
DHAA-G-G3/Q5-B13-HGDD/-HGDT**

**Information**

The kit contains all the mounting attachments that may be required.

- Observe that, for some combinations, mounting components may be left over.

**Mounting**

- Select the mounting components (screws, etc.) for your combination (→ Table).
- Observe the illustration assignment for your combination (→ Table).

Fig. 1

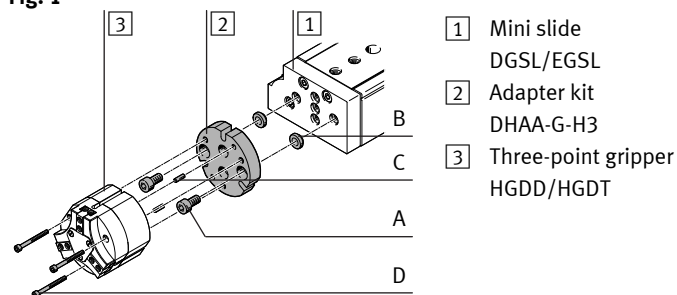

- 1 Mini slide  
DGSL/EGSL
- 2 Adapter kit  
DHAA-G-H3
- 3 Three-point gripper  
HGDD/HGDT

Fig. 2

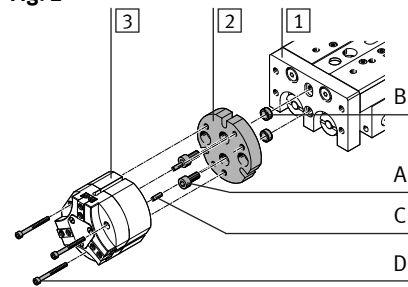

- 1 Mini slide  
SLT
- 2 Adapter kit  
DHAA-G-H3
- 3 Three-point gripper  
HGDD/HGDT

Fig. 3

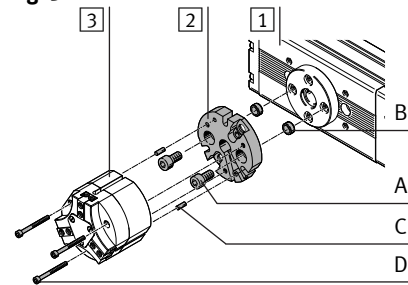

- 1 Semi-rotary drive  
DRQD
- 2 Adapter kit  
DHAA-G-Q5
- 3 Three-point gripper  
HGDD/HGDT

Fig. 4

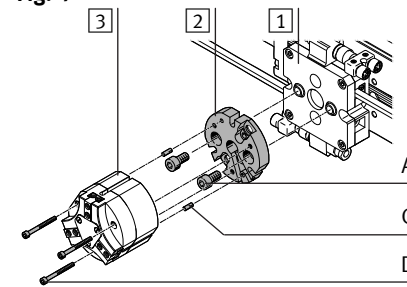

- 1 Semi-rotary drive  
DRQD-...-E422/-E444
- 2 Adapter kit  
DHAA-G-Q5
- 3 Three-point gripper  
HGDD/HGDT

Fig. 5

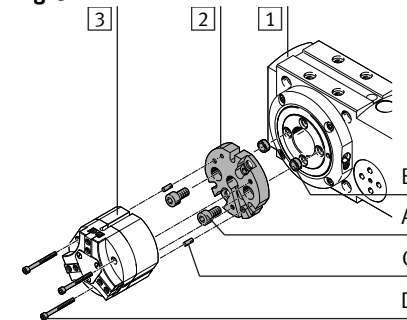

- 1 Rotary module  
ERMB
- 2 Adapter kit  
DHAA-G-Q5
- 3 Three-point gripper  
HGDD/HGDT-34/35

Fig. 6

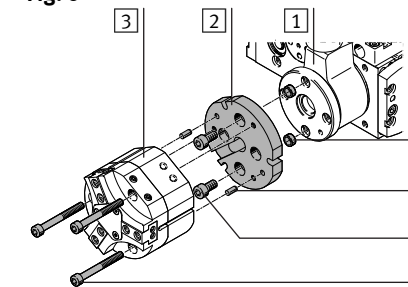

- 1 Rotary/lifting module  
EHMB
- 2 Adapter kit  
DHAA-G-Q5
- 3 Three-point gripper  
HGDD/HGDT

Fig. 7

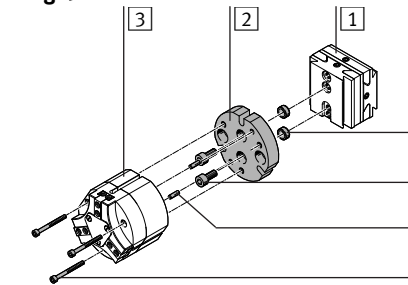

- 1 X/Y adjusting unit  
HMX Y
- 2 Adapter kit  
DHAA-G-H3
- 3 Three-point gripper  
HGDD/HGDT

Fig.	1	2	3	4	5	6	7	
1 Drive	DGSL- 16 20/25	EGSL- 45/55 75	SLT- 20 25	DRQD- 20 25/32 25/32	DRQD-...-E422/-E444- 20 25/32 25/32	ERMB- 20 25/32 25/32	EHMB- 20	HMX Y- 1
2 Kit	DHAA-G-G3-20- B13- 35	DHAA-G-G3-20- B13- 35	DHAA-G-G3-20- B13- 35	DHAA-G-Q5- 20-B13- 35 40	DHAA-G-Q5- 20-B13- 35 40	DHAA-G-Q5- 20-B13- 35 40	DHAA-G-Q5- 20-B13- 35 40	DHAA-G-G3-20- B13- 35
3 Gripper	HGDD-/HGDT- 35	HGDD-/HGDT- 35	HGDD-/HGDT- 35	HGDD-/HGDT- 35 40	HGDD-/HGDT- 35 40	HGDD-/HGDT- 35 40	HGDD-/HGDT- 35 40	HGDD-/HGDT- 35
	$M_A^{1)}$ [Nm]							
<b>A Socket head screw in accordance with DIN 912</b>								
M4x10	3			2x		2x		
M4x30					2x			
M5x12	6	2x	2x	2x				2x
M6x12	10	2x	2x	2x	2x	2x	2x	2x
M6x16								
M6x35					2x	2x		
<b>B Centring sleeve</b>								
ZBV-9-7	2x	2x						
ZBV-12-9		2x	2x					
ZBH-7				2x		2x		
ZBH-9			2x	2x	2x		2x	2x
ZBH-12			2x					
<b>C Cylindrical dowel pin in accordance with DIN 6325</b>								
3m6x10		2x	2x	2x	2x	2x	2x	2x
4m6x10					2x		2x	2x
<b>D Socket head screw in accordance with DIN 912</b>								
M3x30	1,2	3x	3x	3x	3x	3x	3x	3x
M5x30	6				3x	3x	3x	3x

<sup>1)</sup> Tolerances for non-toleranced tightening torques  $M_A$   
 $M_A > 1 \text{ Nm}$ : ± 20 %