

**Kabel
FEC-KBG7 / FEC-KBG8**

539 642 / 539 643

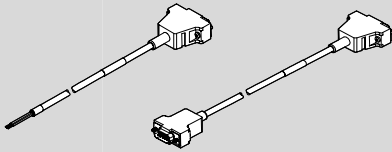

1. Kabel FEC-KBG7

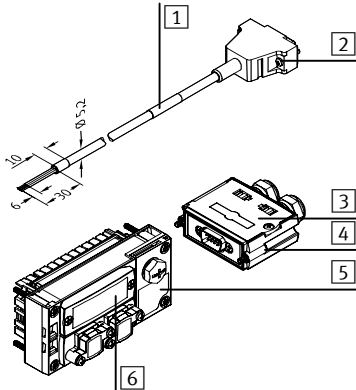

- 1 Kabel FEC-KBG7 (539642)
- 2 Befestigungsschrauben 4-4UNC
- 3 Feldbusstecker FBS-SUB-9-GS-1x9POL-B (534497)
- 4 Befestigungsschrauben
- 5 Steuerblock CPX-FEC-...
- 6 Abdeckung
- 7 Montageanleitung des Feldbussteckers

2. Montageschritte Kabel FEC-KBG7 (CPX-FEC-Seite)

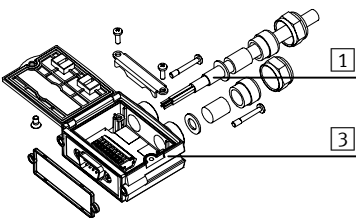

- 1. Zur Konfektionierung mit Feldbusstecker:

Kont. Belegung	Aderfarbe	Signal
Pin 2	grün	RxD
Pin 3	weiß	TxD
Pin 5	braun	GND
Pin 1,4,6-9	nicht belegt	
Gehäuse	Schirm	

Beachten Sie diese Kontaktbelegung und die Montageanleitung

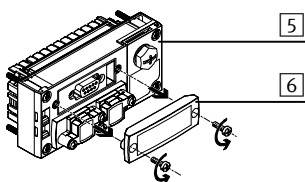

- 2. Entfernen Sie die Abdeckung vom Steuerblock.

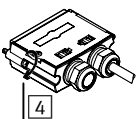

- 3. Beachten Sie das Anzugsdrehmoment der Schrauben (siehe Montageanleitung).

3. Montageschritte Kabel FEC-KBG7 (FED-50-Seite)

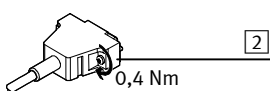

- 1. Beachten Sie das Anzugsdrehmoment der Schrauben.

4. Kontaktbelegung Kabel FEC-KBG7

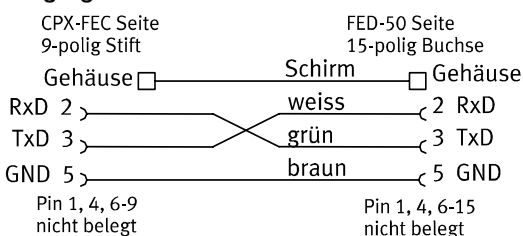

1. Kabel FEC-KBG8

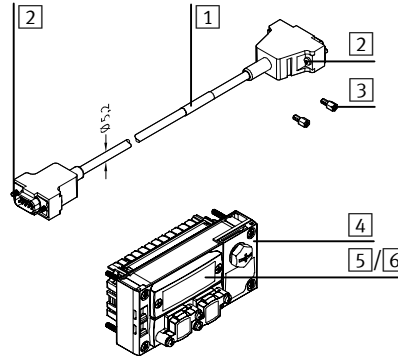

- 1 Kabel FEC-KBG8 (539643)
- 2 Befestigungsschrauben 4-4UNC
- 3 Verriegelungsbolzen 4-4UNC
- 4 Steuerblock CPX-FEC-...
- 5 Abdeckung
- 6 M3 Schrauben

2. Montageschritte Kabel FEC-KBG8 (CPX-FEC-Seite)

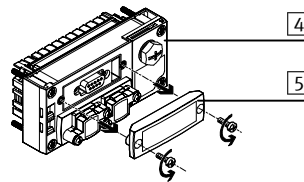

- 1. Entfernen Sie die Abdeckung vom Steuerblock.

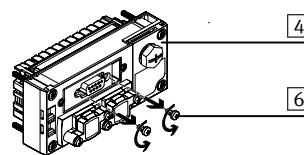

- 2. Drehen Sie die Schrauben am Sub-D Stecker heraus.

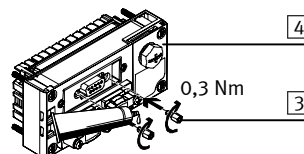

- 3. Drehen Sie die mitgelieferten Bolzen ein. Sichern Sie die Bolzen ggf. mit einem Schraubensicherungsmittel.

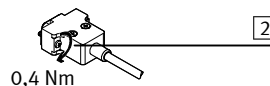

- 4. Beachten Sie das Anzugsdrehmoment der Schrauben.

3. Montageschritte Kabel FEC-KBG8 (FED-50-Seite)

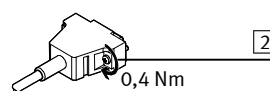

- 1. Beachten Sie das Anzugsdrehmoment der Schrauben.

4. Kontaktbelegung Kabel FEC-KBG8

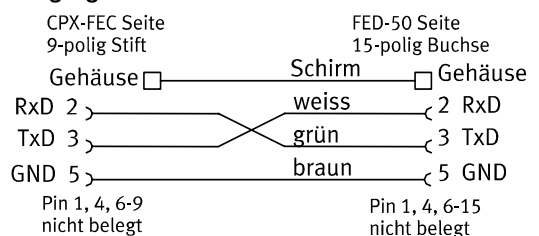

**Cable
FEC-KBG7 / FEC-KBG8**

539 642 / 539 643

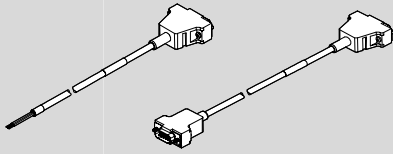

1. Cable FEC-KBG7

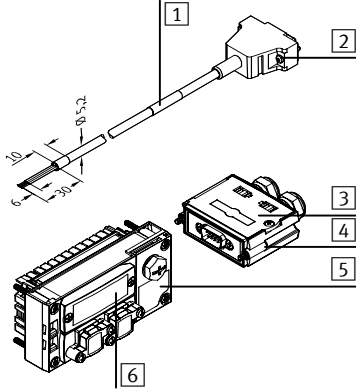

- 1 cable
FEC-KBG7 (539642)
- 2 fastening screws
4-4UNC
- 3 field bus plug
FBS-SUB-9-GS-1x9POL-
B (534497)
- 4 fastening screws
- 5 control unit CPX-FEC-...
- 6 cover
- 7 assembly instructions
for field bus plug 3

2. Assembly steps for cable FEC-KBG7 (CPX-FEC side)

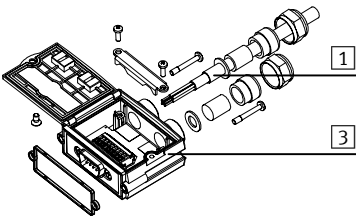

- 1. For assembly with field
bus plug 3:

Pin assignment	Core colour	Signal
Pin 2	green	RxD
Pin 3	white	TxD
Pin 5	brown	GND
Pin 1,4,6-9	not assigned	
Housing	screening	

Please note this pin
assignment and these
assembly instructions 7

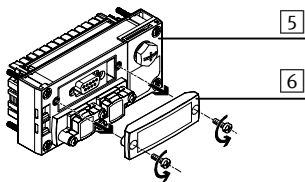

- 2. Remove the cover 6 from
control unit 5.

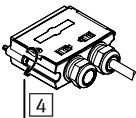

- 3. Please note the tightening
torque of screws 4 (see
assembly instructions 7).

3. Assembly steps for cable FEC-KBG7 (FED-50 side)

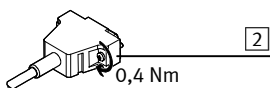

- 1. Please note the tightening
torque of screws 2.

4. Pin assignment of cable FEC-KBG7

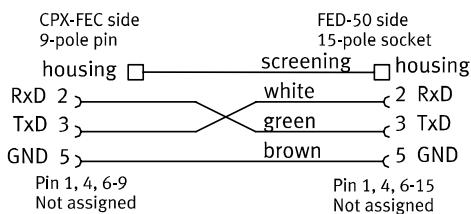

1. Cable FEC-KBG8

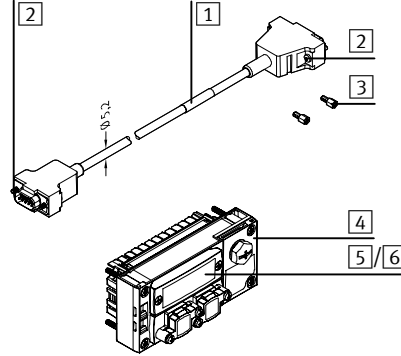

- 1 cable
FEC-KBG8 (539643)
- 2 fastening screws
4-4UNC
- 3 locking bolt
4-4UNC
- 4 control unit CPX-FEC-...
- 5 cover
- 6 M3 screws

2. Assembly steps for cable FEC-KBG8 (CPX-FEC side)

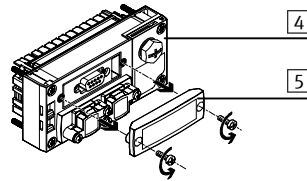

- 1. Remove cover 5 from
control unit 4.

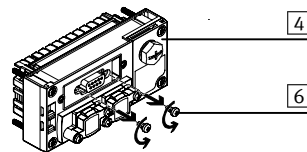

- 2. Remove screws 6 from
the sub-D plug.

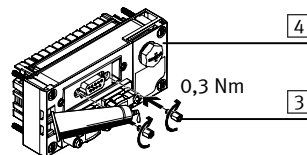

- 3. Screw in the bolts 3
provided.
Lock bolts 3, if neces-
sary, with a screw locking
medium.

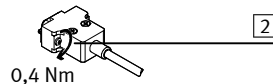

- 4. Please note the tightening
torque of screws 2.

3. Assembly steps for cable FEC-KBG8 (FED-50 side)

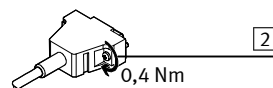

- 1. Please note the tightening
torque of screws 2.

4. Pin assignment of cable FEC-KBG8

