

## Adapterbausatz HAPG-SD2-...-HGD/DHDS

# FESTO

Festo AG & Co. KG

Postfach  
73726 Esslingen  
Deutschland  
+49 711 347-0  
www.festo.com

### Info

Der Bausatz enthält alle maximal erforderlichen Befestigungselemente.

- Beachten Sie, dass bei einigen Kombinationen Befestigungselemente übrig bleiben.

### Zur Montage

- Wählen Sie die Befestigungselemente (Schrauben usw.) für Ihre Kombination (→ Tabelle).
- Beachten Sie die Bildzuordnung für Ihre Kombination (→ Tabelle).

Bild 1

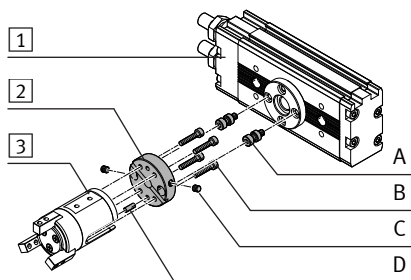

- 1 Schwenkantrieb DRQD-...-FW
- 2 Adapterbausatz HAPG-SD2
- 3 Dreipunktgreifer HGD/DHDS

Bild 2

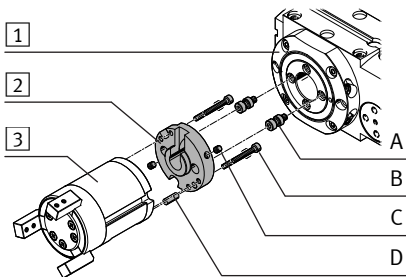

- 1 Drehmodul ERMB
- 2 Adapterbausatz HAPG-SD2
- 3 Dreipunktgreifer HGD/DHDS

Bild 3

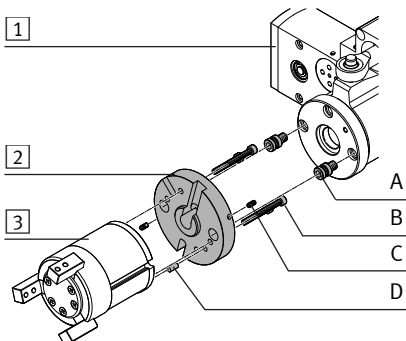

- 1 Dreh-Hub-Modul EHMB
- 2 Adapterbausatz HAPG-SD2
- 3 Dreipunktgreifer HGD/DHDS

Bild 4

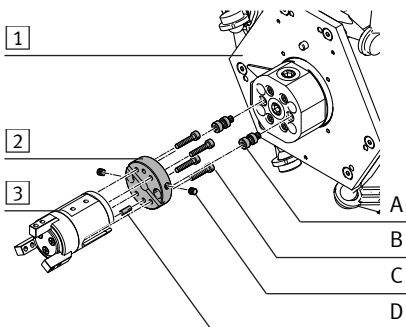

- 1 Stabkinematik EXPT
- 2 Adapterbausatz HAPG-SD2
- 3 Dreipunktgreifer DHDS

Bild	1	2	3	4
1 Antrieb	<b>DRQD-...-FW-</b> 16 20 25 32 40 50	<b>ERMB-</b> 20 25 32	<b>EHMB-</b> 20 25 32	<b>EXPT-</b> 45/70/95/120 <sup>2)</sup>
2 Bausatz	<b>HAPG-SD2-</b> 13 5 8 11 20	<b>HAPG-SD2-</b> 5 8 11	<b>HAPG-SD2-</b> 11 20	<b>HAPG-SD2-</b> 13
3 Greifer	<b>HGD-/DHDS-</b> 16 32 50 50	<b>HGD-/DHDS-</b> 32 50	<b>HGD-/DHDS-</b> 50 50	<b>DHDS-</b> 16
	$M_A^{1)}$ [Nm]			
<b>A Gewindebolzen</b>				
HAPG-ZB-7	3	2x	2x	2x
HAPG-ZB-9	10		2x	
HAPG-ZB-12-B	20		2x	2x
<b>B Zylinderschraube nach DIN 912</b>				
M3x16	1,2	4x		4x
M3x20		4x		
M5x25	6		4x	4x
M5x30			4x	4x
<b>C Gewindestift nach DIN 914</b>				
M4x6	3	2x	2x	2x
M4x12			2x	2x
<b>D Zylinderstift nach DIN 7</b>				
3m6x8		1x		1x
4m6x10			1x	
5m6x10			1x	1x

<sup>1)</sup> Toleranzen für nicht tolerierte Anziehdrehmomente  $M_A > 1 \text{ Nm}$ :  $\pm 20 \%$

<sup>2)</sup> -nicht bei EXPT-...-T0  
-pneumatische Greifer nur bei EXPT-...-T2 und EXPT-...-T4

**Adapter kit  
HAPG-SD2-...-HGD/DHDS**

**i Information**

The kit contains all the mounting attachments that may be required.

- Observe that, for some combinations, mounting attachments may be left over.

**On mounting**

- Select the mounting components (screws, etc.) for your combination (→ Table).
- Observe the illustration assignment for your combination (→ Table).

**Fig. 1**

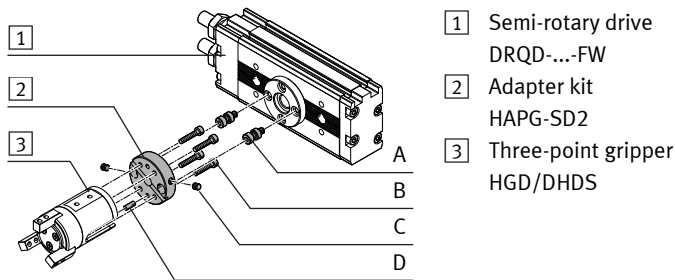

- 1 Semi-rotary drive DRQD-...-FW
- 2 Adapter kit HAPG-SD2
- 3 Three-point gripper HGD/DHDS

**Fig. 2**

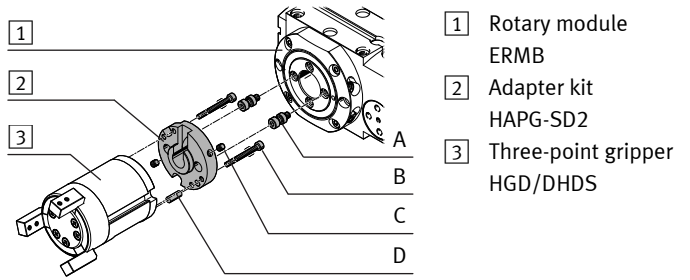

- 1 Rotary module ERMB
- 2 Adapter kit HAPG-SD2
- 3 Three-point gripper HGD/DHDS

**Fig. 3**

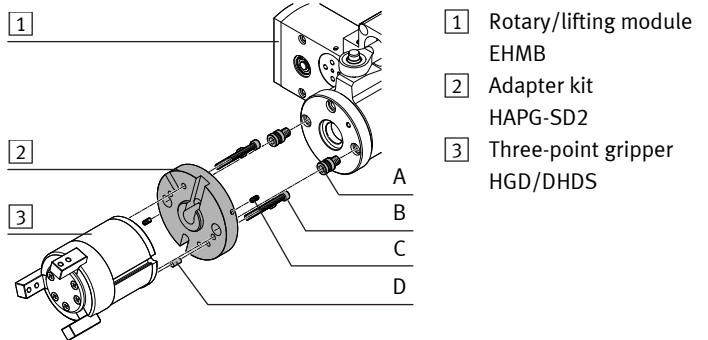

- 1 Rotary/lifting module EHMB
- 2 Adapter kit HAPG-SD2
- 3 Three-point gripper HGD/DHDS

**Fig. 4**

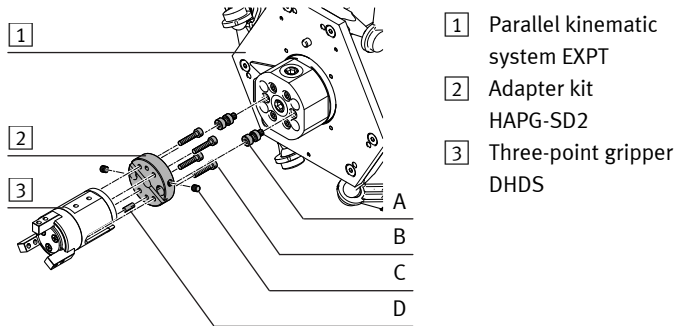

- 1 Parallel kinematic system EXPT
- 2 Adapter kit HAPG-SD2
- 3 Three-point gripper DHDS

Fig.	1	2	3	4
1 Drive	<b>DRQD-...-FW-</b>	<b>ERMB-</b>	<b>EHMB-</b>	<b>EXPT-</b>
	16 20 25 32 40 50	20 25 32	20 25 32	45/70/95/120 <sup>2)</sup>
2 Kit	<b>HAPG-SD2-</b>	<b>HAPG-SD2-</b>	<b>HAPG-SD2-</b>	<b>HAPG-SD2-</b>
	13 5 8 11 20	5 8 11	11 20	13
3 Gripper	<b>HGD-/DHDS-</b>	<b>HGD-/DHDS-</b>	<b>HGD-/DHDS-</b>	<b>DHDS-</b>
	16 32 50 50	32 50	50 50	16
	$M_A$ <sup>1)</sup> [Nm]			
<b>A Threaded bolts</b>				
HAPG-ZB-7	3	2x	2x	2x
HAPG-ZB-9	10		2x	
HAPG-ZB-12-B	20		2x	
<b>B Socket head screw in accordance with DIN 912</b>				
M3x16	1.2	4x		4x
M3x20		4x		
M5x25	6		4x	
M5x30			4x	
<b>C Threaded pin in accordance with DIN 914</b>				
M4x6	3	2x	2x	2x
M4x12			2x	2x
<b>D Cylindrical dowel pin in accordance with DIN 7</b>				
3m6x8		1x		1x
4m6x10			1x	
5m6x10			1x	1x

<sup>1)</sup> Tolerances for non-toleranced tightening torques  $M_A > 1 \text{ Nm}$ :  $\pm 20 \%$

<sup>2)</sup> -Not for EXPT-...-T0  
- Pneumatic gripper only with EXPT-...-T2 and EXPT-...-T4